

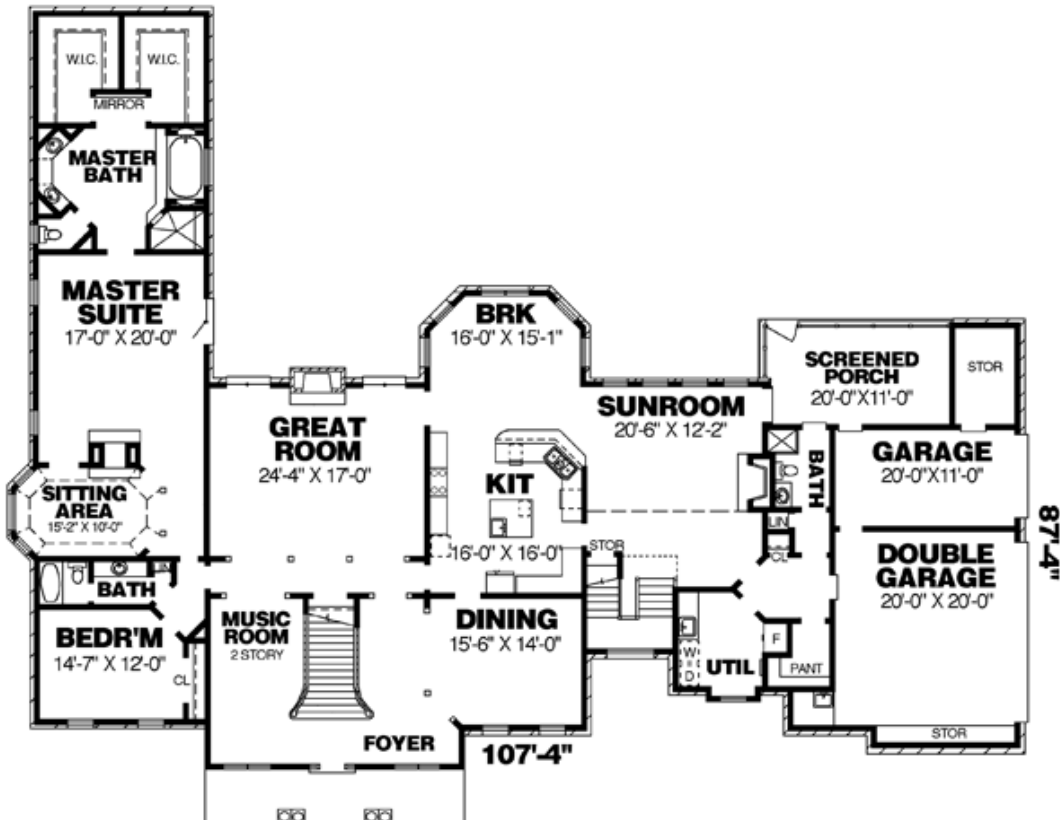

6508 Dover

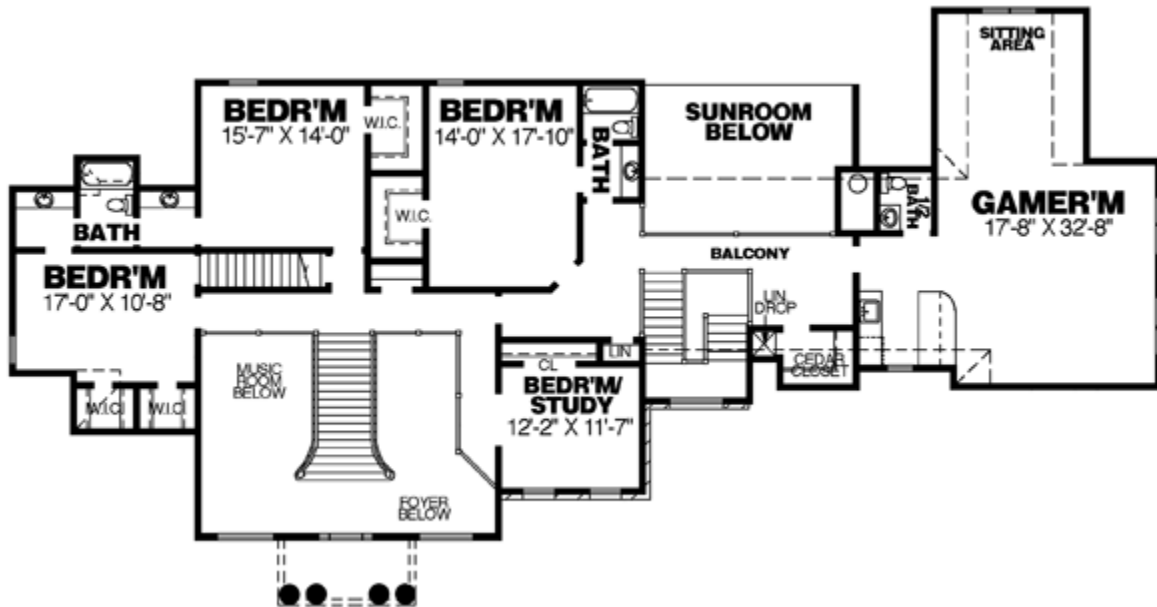



- **Total Living Area: 6508**

- Main Living Area: 4063
- Upper Living Area: 2445
- Garage Type: Attached
- Garage Bays: 3
- House Width: 108'
- House Depth: 88'
- Number of Stories: 2
- Bedrooms: 6
- Full Baths: 5
- Half Baths: 1
- Primary Roof Pitch: 9:12
- Roof Load: 20 psf
- Roof Framing: Stick
- Porch: 357 sq ft
- Formal Dining Room: Yes
- FirePlace: Yes
- 1st Floor Master: Yes