

  
1800 Springfield

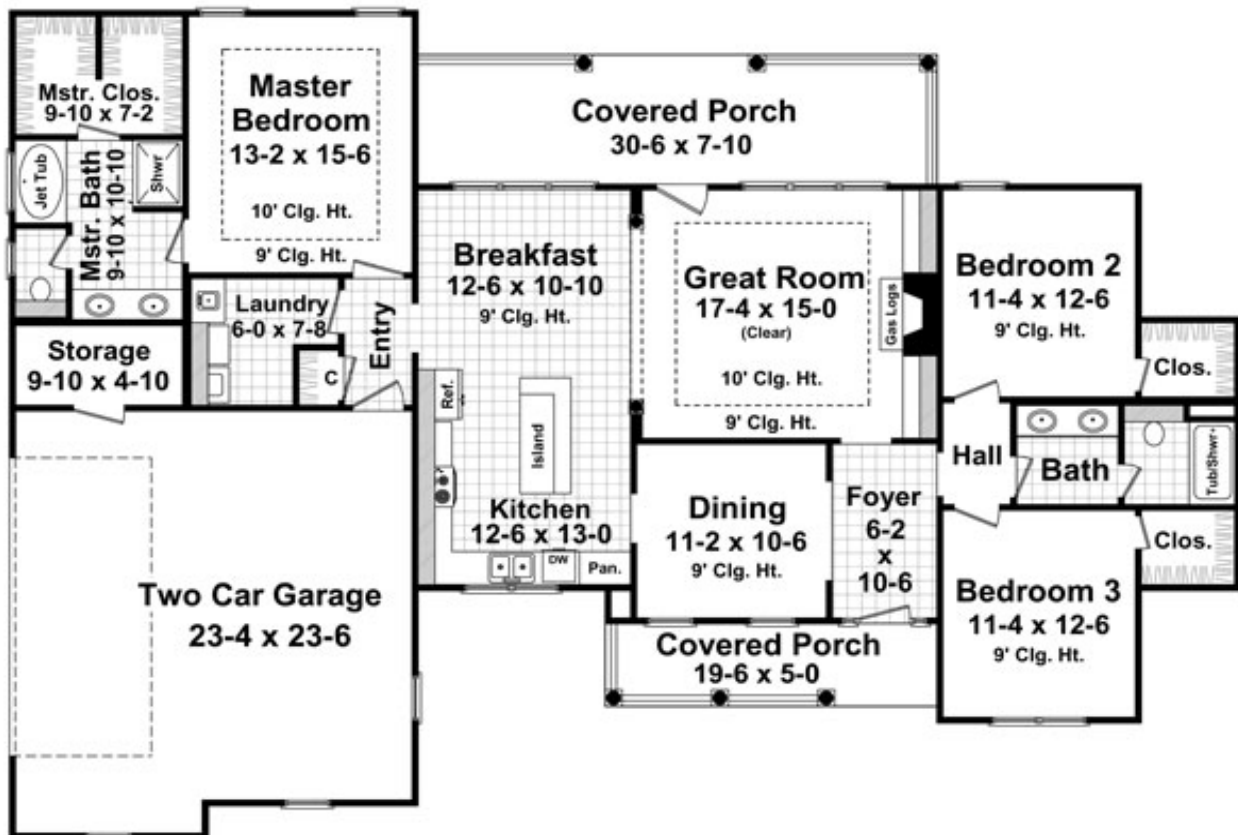

- **Total Living Area: 1800**
- Main Living Area: 1800
- Garage Type: Attached
- Garage Bays: 2
- House Width: 72'4
- House Depth: 50'
- Number of Stories: 1
- Bedrooms: 3
- Full Baths: 2
- Max Ridge Height: 21'9
- Primary Roof Pitch: 8:12
- Roof Load: 30 psf
- Roof Framing: Stick
- Porch: 336 sq ft
- Formal Dining Room: Yes
- FirePlace: Yes
- 1st Floor Master: Yes
- Main Ceiling Height: 9'